

ANVIZ

Secure Workplace, Simplify Management

M7 Palm

Outdoor Professional
Standalone Access
Control Device



Palm Vein



IP66



PoE



Wiegand



The M7 Palm is an outdoor professional standalone access control device. With a narrow metal exterior design and the latest BioNANO® palm vein recognition algorithm, the scanning speed is fast and accurate. Equipped with a low power consumption OLED screen, it ensures a long lifetime and a smooth HCI experience. PoE power supply ensures easy installation, and the IK10 vandal-proof ensures the stability and reliability of the device. Its rich access interfaces can connect locks, exit buttons, door contacts, doorbells, etc. It can be widely used in industries with high-security requirements, such as government, judicial, and banking.

M7 Palm

Outdoor Professional Standalone Access Control Device

■ Features



BioNano's New Palm Vein Recognition Algorithm

Non-contact palm vein recognition a highly secured biometric verification is suitable for many people.



Smart Distance Measurement

Adopt ToF laser-ranging providing accurate distance measurement, regardless of hand skin and skin color.



IP66 Outdoor

The standard IP66 design ensures the complete outdoor application of the device.



IK10 Vandal Proof

The IK10 standard ensures strong vandal-proof and stable outdoor application and installation.



OLED Screen

The OLED screen ensures the best interaction and user experience and can also provide clear notifications to the users.



Rich Access Control Interface

The Wiegand out interface can easily connect to the standard third-party controller and it can also trigger the lock directly by its built-in relay.



PoE Power Supply & Communicaiton

PoE can provide centralized power management and efficiency, as well as the ability to remotely reboot devices, making it a convenient and flexible solution for many networking applications.



Two-factor Security

Biometric Palm Vien Recognition linked with RFID card or PIN code. Supports multiple recognition methods.

■ Key Specifications

Palm Vein	Identification speed	Under 0.5s
	Identification Distance	10~30cm
	FAR	0.00008%
	FRR	0.01%
	Smart distance measurement	ToF laser-ranging
Hardware	Screen	High-Light OLED
	Communication	RS485, TCP/IP
	Credential	Palm Vien, RFID Card, Pin Code
	Kaypad	17 keys button
	Interface	Wiegand out, Relay out, Door contact, Exit button, Door bell
	Work Temperature	-30°C~60°C
	Operating Humidity	20% to 80% relative humidity (non-condensing)
	Power	Standard PoE IEEE 802.3af and DC 12V
	Protection	IP66 & IK10
Capacity	Palm Users	500
	RFID Users	500
	Records	50,000

■ System Configurations

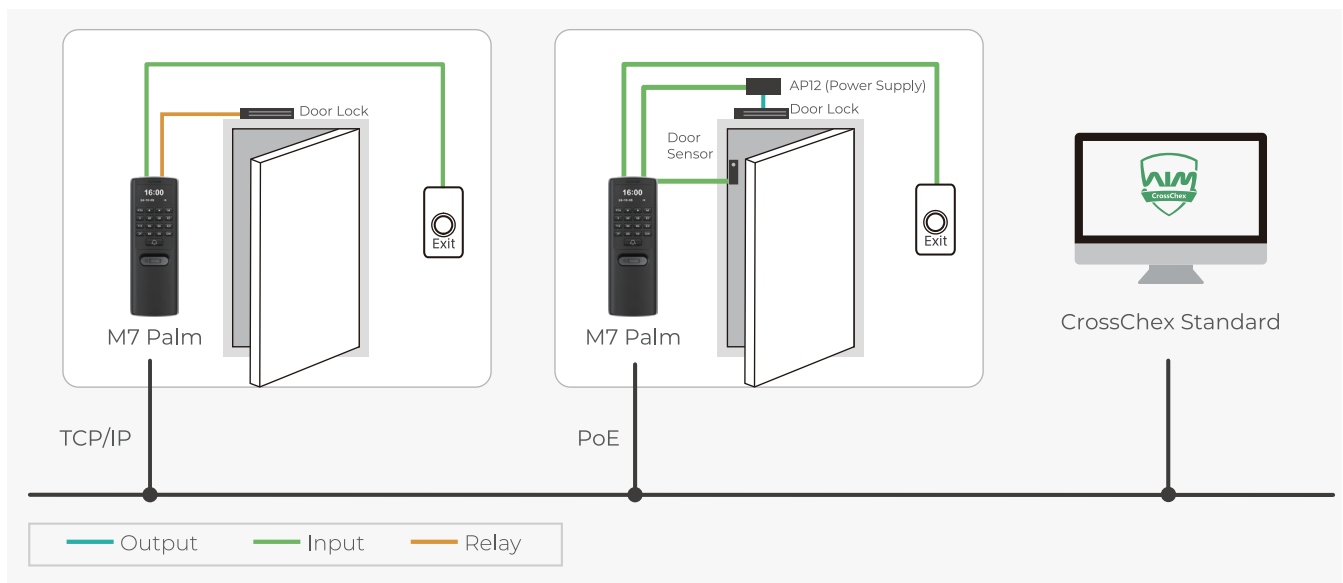

Anviz Global

32920 Alvarado-Niles Rd Ste 220, Union City, CA 94587

Toll-free: 1-855-268-4948 | sales@anziv.com | www.anviz.com

©2024 Anviz Global Inc. Anviz and identifying product names and numbers herein are registered trademarks of Anviz Global Inc. All non-Anviz brands and product names are trademarks or registered trademarks of their respective companies. Product appearance, build status and/or specifications are subject to change without notice.